



归宿 / Home

归宿

为什么工具不能有一个很好的

Where is the **HOME** for tools?



拉杆式工具箱 / Roller tool case



特点速递 / Features at glance



- 金属框架结构，保证箱体稳定
Sturdy case body by integrating design between the bottom and the metal frame
- 四周框架保护，避免边角的损坏
Metal angles to protect the edges and corners



- 前立面可45°打开，便于工具拿取
45° foldable front panel makes it easy to take the tools
- 打开侧面由牛津帆布防护，防止细小工具遗失
Two side curtains to prevent the loss of tiny tools

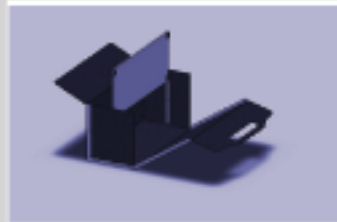

- 松紧带与工具袋结合，可更好固定工具
Tool pockets together with elastic band to fix tools better



- 把手、拉杆承重设计，保证使用安全
Heavy duty telescopic and carrying handle to assure your use in safety



- 静音滑轮，使出行更加舒适
The rubber coated wheels makes your trip more easy and silent.



中间隔板可更换，以满足不同应用
Removable panel for different applications





订货编号: RTC-01-460

外部尺寸: 460x365x220mm

内部尺寸: 445x350x200mm

外部材料: 真皮, 黑色

内部材料: 结实牛津布, 黑色

箱体净重: 7.2kg

额定载重: 25kg

Product code: RTC-01-460

Exterior dimension: 460x365x220mm

Interior dimension: 445x350x200mm

Exterior material: genuie leather, black

Interior material: anti-abrasive oxford

Weight: 7.2kg

Max. loading capacity: 25kg



维修工程师工具收纳示意图 / Sketch for the maintenance engineer tool case

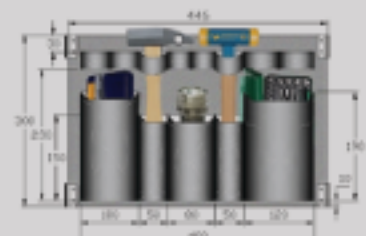
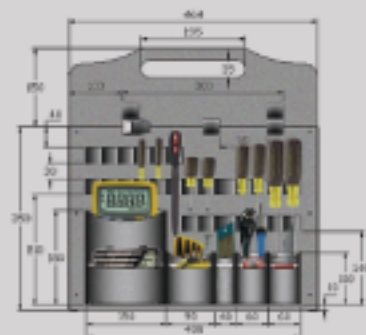
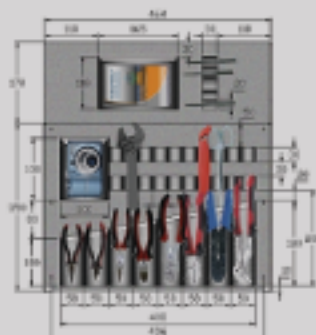

主要参数 / main specifications



订货编号: RTC-01-450

外部尺寸: 450x325x195mm
内部尺寸: 435x305x175mm
外部材料: 真皮, 黑色
内部材料: 结实牛津布, 黑色
箱体净重: 6.0kg
额定载重: 25kg

Product code: RTC-01-450

Exterior dimension: 450x325x195mm
Interior dimension: 435x305x175mm
Exterior material: genuie leather, black
Interior material: anti-abrasive oxford
Weight: 6..0kg
Max. loading capacity: 25kg



综合服务工程师工具收纳示意图 / Sketch for comprehensive engineer tool case

